

HZB2-300 Valve Regulated Lead Acid battery, 15 year design life for stand by power applications. 2 Volts 300 Ah @ C10

Innovative Features

- Completely maintenance free, sealed construction eliminates the need for watering
- Increased durability and deep cycle ability for heavy demand applications
- Fully tank formed plates
- Analytical Grade electrolyte
- Spill proof / leak proof
- Valve regulated Max internal pressure 2.5 psi
- Multi-position usage
- ABS Case and cover - V0 on request
- Low self discharge
- FAA and IATA approved as non-hazardous
- Built to comply with IEC 896-2, DIN 43534, BS 6290 Pt4, Eurobat.



Specifications

Nominal Voltage	2 Volts
Nominal Capacity	300Ah (C10 @ 25 °C)
Design Life	15 Years
Cycle life	1800 Cycles @ 25 °C
Operating Temperature	-20 °C to 50 °C
Grid alloy	Calcium / Tin lead alloy
Plates	Flat Pasted
Separator	Absorbant Glass Mat
Active material	Very high purity lead
Case and cover	ABS (VO on request)
Charge Voltage	Float 2.27 - 2.30 VPC @25 °C Cycling 2.35 @25 °C Max. 2.4 VPC Max ripple 0.05C (A)
Electrolyte	Sulphuric acid Analytical grade purity
Venting Valve	EPDM Rubber 1.5 to 2 psi (10.5 - 14 KPa) release pressure. Resealing at 1 psi (7 KPa)
Terminal	Insert 18mm Dia M8 thread. Epoxy sealed by extended mechanical paths
Torque setting	The recommended torque value for all types is 5-7 Nm
Cables	Connectors supplied as standard, cables on request.

2V
AGM

Sealed Lead Acid 2 Volt Bloc AGM Range

PRODUCT SHEET HZB2-300

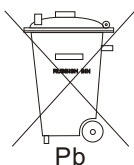

Haze Battery Company keenly encourages environmental awareness; PLEASE follow guidelines for the recycling /disposal of lead.

Website: www.hazebattery.com
E mail : sales@hazebattery.com

Specifications

Nominal Voltage		2V	
Nominal Capacity		300 Ah	C10
Dimensions	Total Height (Inc. terminals)	330 mm n/a mm	12.99 inches n/a inches
	Length	171 mm	6.73 inches
	Width	151 mm	5.94 inches
	Weight	18.1 Kg	40.00 lbs

Characteristics

Capacity 20 °C (68 °F) To 1.7 volts	20 hour rate	331.6 Ah
	10 hour rate	318.8 Ah
	5 hour rate	279.5 Ah
	1 hour rate	189.3 Ah
	15 min rate	100.0 Ah
	Internal Resistance	0.75 mOhms
Capacity correction for Temperature Variations (C20)	Impedance	S
	40 °C (104 °F)	102%
	20 °C (68 °F)	100%
	0 °C (32 °F)	85%
Self-Discharge 20 °C (68 °F)	-15 °C (5 °F)	65%
	Capacity after 1 months storage	98%
	Capacity after 3 months storage	94%
Short Circuit Current 20 °C (68 °F)	Capacity after 6 months storage	86%
	Standard	2400
Terminal	Optional	16mm Insert M6 thread
	Charging (Constant Voltage)	Cyclic
	Float	2.27 - 2.30 VPC (15-25 °C)

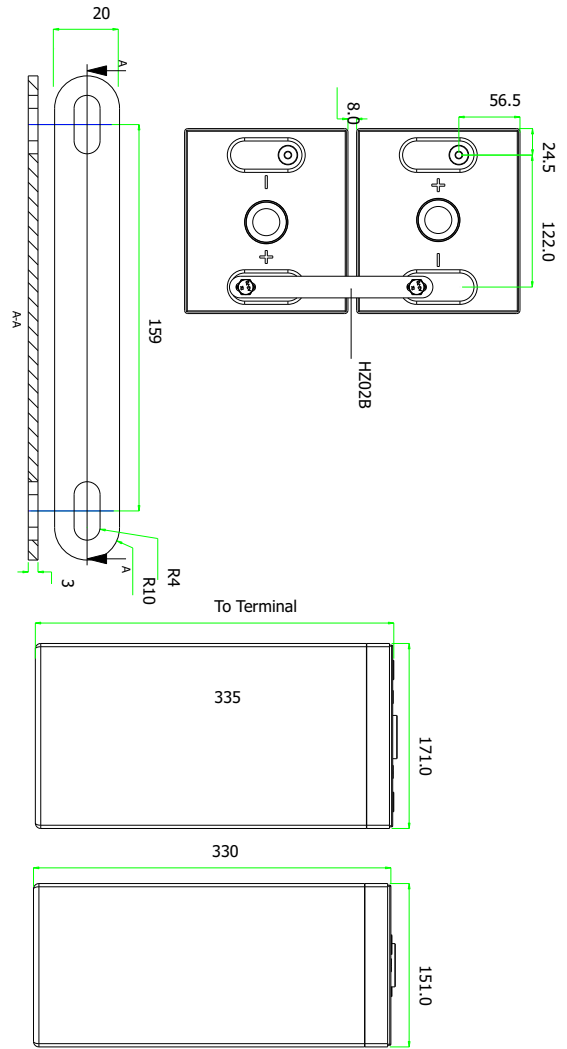

Constant Power Discharge - Watts per Cell @20-25 °C

End V per Cell	5M	10M	15M	20M	25M	30M	35M	40M	45M	60M	90M	2 hr	3 hr	4 hr	5 hr	6 hr	7 hr	8 hr	10hr	12hr	20hr	24hr
1.85	782	715	623	565	520	488	457	432	408	343	257	208	155	125	105.8	91.8	81.6	73.0	60.9	51.7	31.7	26.5
1.80	922	776	670	613	563	525	481	450	422	354	265	214	159	128	108.0	93.7	83.1	74.5	62.0	52.7	32.3	27.1
1.75	998	776	751	655	598	553	507	468	439	364	270	218	162	130	110.0	95.2	84.4	75.4	62.9	53.3	32.8	27.6
1.70	998	776	776	677	610	566	517	477	444	369	273	220	164	133	111.6	96.5	85.4	76.4	63.5	53.8	33.2	27.9
1.65	998	776	776	714	638	579	529	487	453	373	276	223	166	134	-	-	-	-	-	-	-	-

Constant Amps Discharge - Amps @20-25 °C

End V per Cell	5M	10M	15M	20M	25M	30M	35M	40M	45M	60M	90M	2 hr	3 hr	4 hr	5 hr	6 hr	7 hr	8 hr	10hr	12hr	20hr	24hr
1.85	436	382	340	300	276	257	239	224	209	173	132	107	78.8	63.2	53.0	45.9	40.7	36.3	30.2	25.6	15.8	13.2
1.80	512	400	366	323	293	270	252	236	219	180	136	110	80.5	64.5	54.0	46.7	41.6	37.2	30.8	26.2	16.1	13.5
1.75	520	400	386	338	307	283	262	244	226	186	140	113	82.7	65.9	55.1	47.8	42.4	38.0	31.5	26.7	16.4	13.8
1.70	520	400	400	350	314	290	269	249	231	189	142	114	83.6	66.7	55.9	48.6	43.0	38.4	31.9	27.1	16.6	14.0
1.65	520	400	400	359	323	298	274	254	235	193	144	116	84.5	67.9	-	-	-	-	-	-	-	-

Ampere Hour @20-25 °C

End V per Cell	2 hr	3 hr	4 hr	5 hr	6 hr	7 hr	8 hr	10hr	12hr	20hr	24hr
1.85	213	236	253	265	276	285	292	302	307	316	318
1.80	220	242	258	270	281	291	299	308	314	322	324
1.75	226	248	264	276	288	297	305	315	320	327	332
1.70	228	251	267	280	292	301	309	319	325	332	335
1.65	231	254	272	-	-	-	-	-	-	-	-

UL Recognised Component MH28512



120810